

Calculation Data

Luminaire Schedule								
Symbol	Qty	Label	Arrangement	Total Lumens	Total Watts	LLF	BUG Rating	Description
⊙	58	VX891180-C3HMA3-R	SINGLE	5488	85	0.930	B1-U2-G1	VX8911, Clear Panels, 80 LED's, Type III, 4000K CCT, 350mA, 14ft Pole
⊙	21	VX891180-C5HMA3-R	SINGLE	5728	85.4	0.930	B3-U2-G1	VX8911, Clear Panels, 80 LED's, Type V, 4000K CCT, 350mA, 14ft Pole

Calculation Summary								
Label	Calc Type	Units	Avg	Max	Min	Avg/Min	Max/Min	Description
Entry Drive	ILLUMINANCE	Fc	1.43	3.40	0.50	2.86	6.80	15ft Grid
North Parking Lot	ILLUMINANCE	Fc	1.21	3.50	0.50	2.42	7.00	15ft Grid
Walkway Along North Lot	ILLUMINANCE	Fc	1.21	1.50	1.00	1.21	1.50	15ft Grid

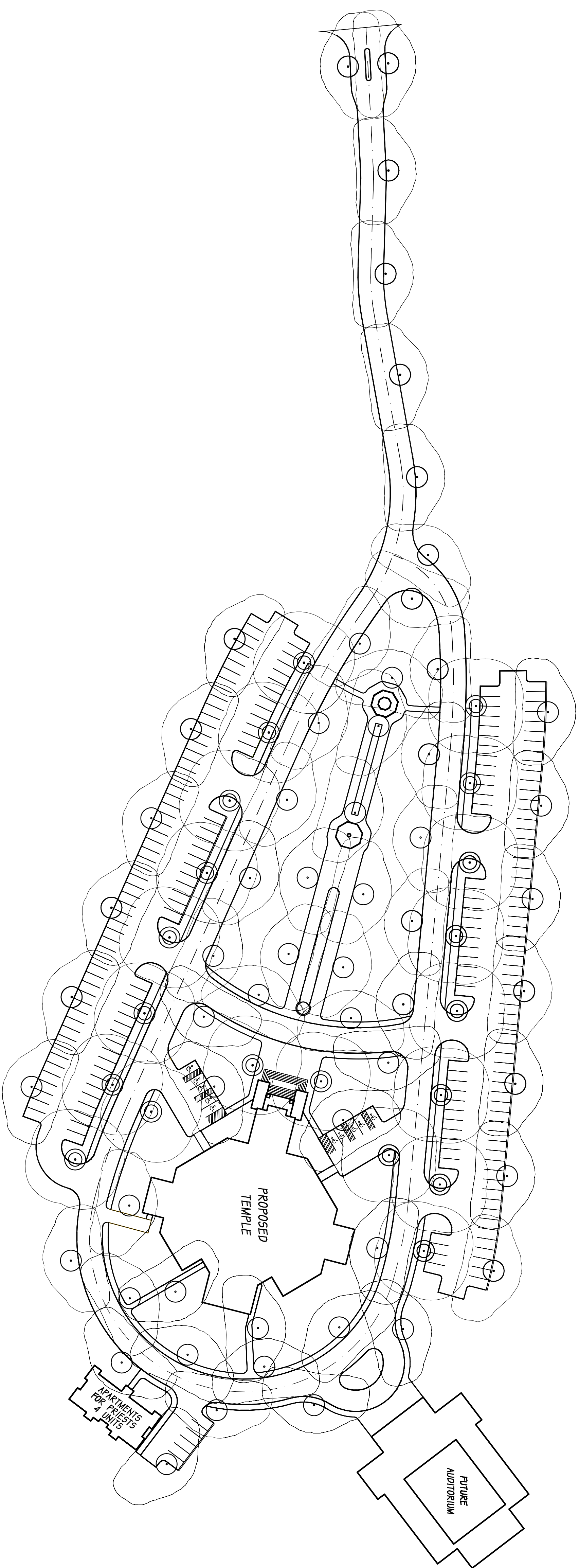

Footcandle results shown on this lighting design are based on project specifications provided to Hado Lighting. Actual conditions differing from these design parameters may affect field results. The customer is responsible for verifying compliance with any applicable lighting codes.

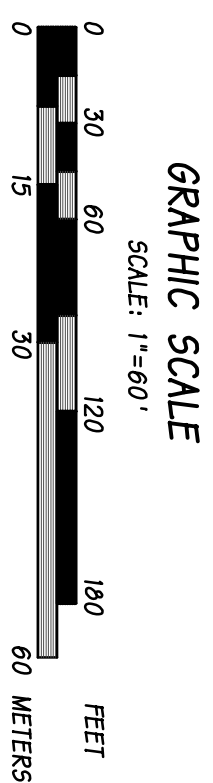

100 Craftway I P.O. Box 128 Littlestown, PA 17340 Phone: 717-359-7131 Fax: 717-359-9515 www.hadco.com		Date: 02/21/2014	Project ID# 130619-21-81	REV: A	Issued By: PMD	Program: AG132 -V2.04 REV01	JOB NAME: Temple at Groton Application Report
PHILIPS HADCO		Contact: Robert Stacey - Hurry Associates - 339.200.8377					

#	DATE	REVISION COMMENT

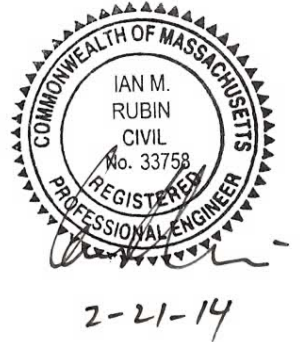

LIGHTING AND PHOTOMETRIC PLANS
 NEW ENGLAND SHIRDI SAI PARIVAAR TEMPLE
 BOSTON ROAD
 GOTON, MASSACHUSETTS

CLIENT:
NESSP, INC.
 290 LITTLETON ROAD, UNIT 4
 CHELMSFORD, MASSACHUSETTS

360 MASSACHUSETTS AVE, SUITE 202
 ACTON, MASSACHUSETTS 01720
 P(978) 264-4600 F(978) 263-0447
 www.MarkeyAndRubin.com

Markey & Rubin
 CIVIL ENGINEERING