

CONSTRUCTION NOTES

- ALL DISTURBED AREAS ARE TO RECEIVE 4" OF LOAM & SEED.
- THE CONTRACTOR SHALL VERIFY ALL DIMENSIONS AND GRADES ON SITE AND SHALL IMMEDIATELY REPORT ANY DISCREPANCIES OR DEVIATIONS FROM THE CONSTRUCTION PLANS TO THE ENGINEER. ALSO REPORT ANY CONDITIONS UNCOVERED IN THE WORK WHICH ARE NOT REFLECTED WITHIN THE PLANS.
- LOCATION AND SIZE OF UTILITIES IS APPROXIMATE ONLY. CONTRACTOR MUST VERIFY PROPOSED CONNECTIONS WITH RESPECTIVE UTILITY COMPANIES PRIOR TO CONSTRUCTION. DIGSAFE SHALL BE NOTIFIED AT LEAST 72 HOURS PRIOR TO ANY EXCAVATION (1-888-344-7233).
- A PORTION OF THE SUBJECT PARCEL IS LOCATED IN THE 100 YEAR FLOOD HAZARD AREA AS DEFINED ON THE FEMA FLOOD INSURANCE RATE MAP, COMMUNITY PANEL NUMBER 25017C0201F AND 25017C0202F, EFFECTIVE JUNE 8, 2023.
- BOUNDARY AND PLANOMETRIC INFORMATION SHOWN HEREON IS COMPILED FROM AN INSTRUMENT SURVEY BY DAVID E. ROSS ASSOC., INC.
- FLAGGED WETLAND AND BANK LOCATION SHOWN ON THIS MAP WERE APPROVED BY THE GROTON CONSERVATION COMMISSION, MASSDEP FILE NO. 169-1190.
- ALL WORK TO BE COMPLETED IN ACCORDANCE WITH THE REQUIREMENTS OF THE GROTON WATER DEPARTMENT.

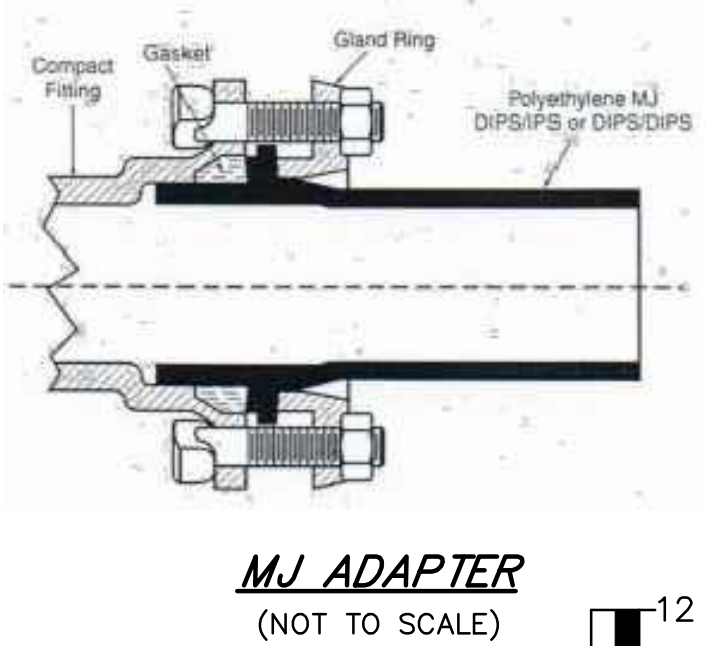

DATE	REVISION	BY

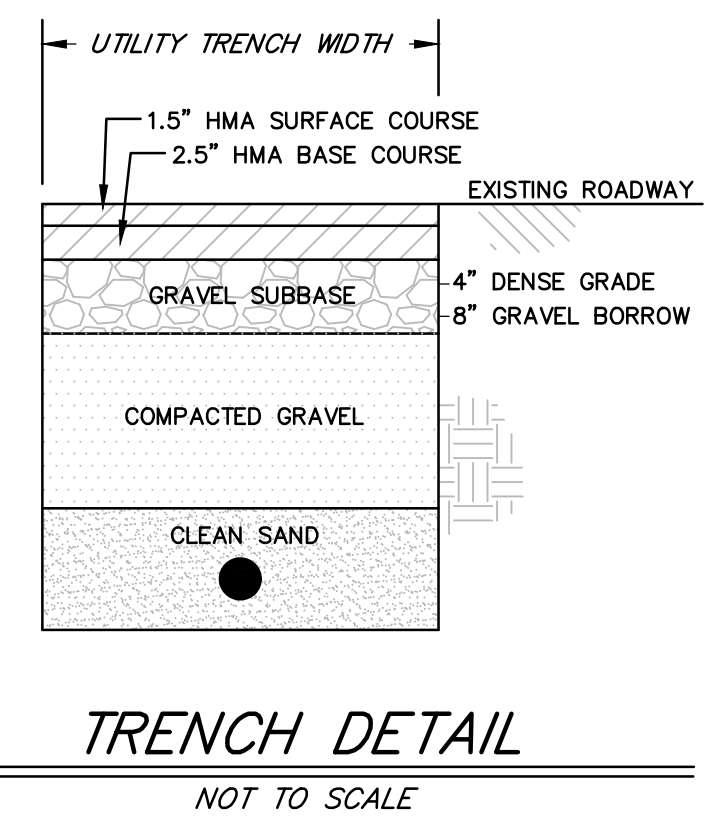
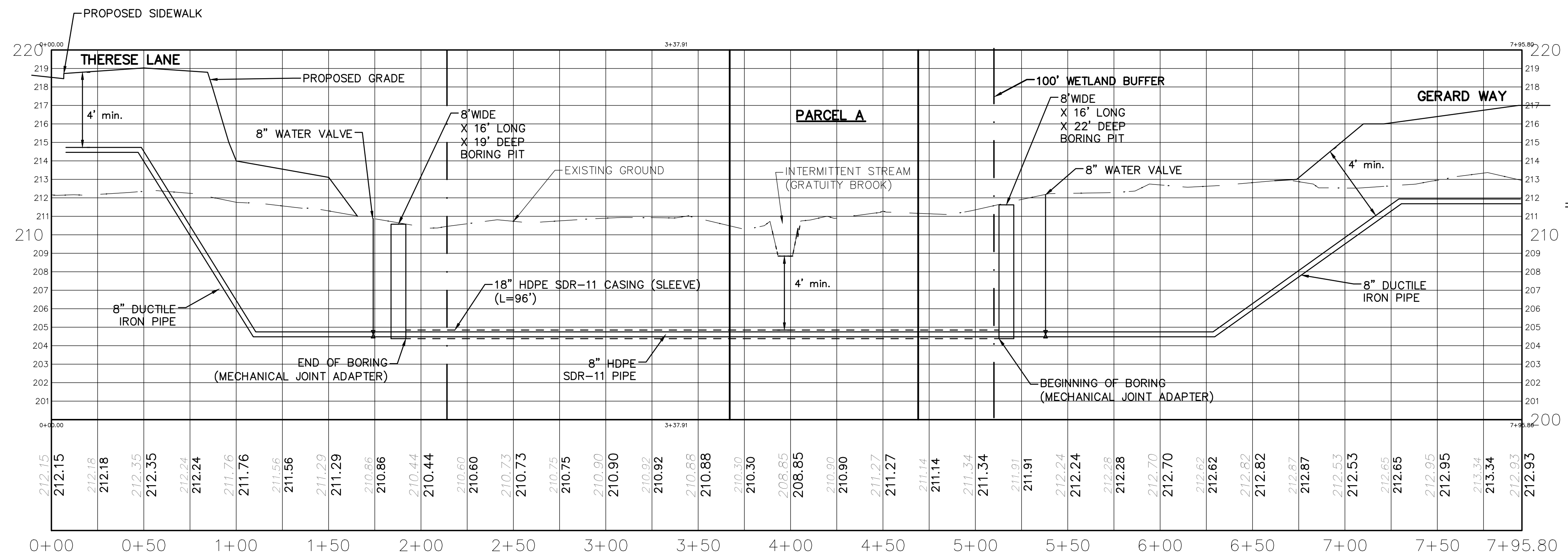
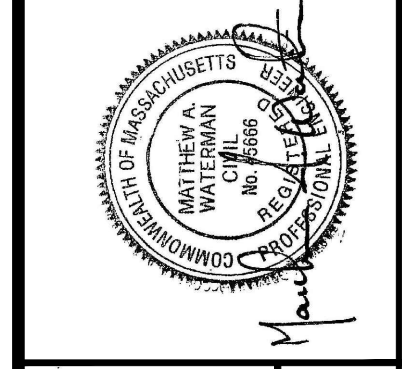

PREPARED FOR:
ROUTHIER & ROPER
GRATUITY ROAD, LLC
236 ATER ROAD,
LITTLETON, MA 01460

DESIGN: HRK
DRAFT: HRK
CHECK: MAW

GRATUITY BROOK FARM ESTATES
EXHIBIT - DIRECTIONAL DRILLING
63 GRATUITY ROAD
GROTON, MA

MARCH 6, 2025

SCALE: 1" = 40'

REPRODUCTION OF THIS PLAN IN WHOLE OR PART IS PROHIBITED WITHOUT THE WRITTEN CONSENT OF THE DESIGN ENGINEER AND/OR FIRM.

Landtech
Consultants

515 Groton Road • Westford, MA 01886 • (978) 892-6100 • www.landtechinc.com
Copyright © 2025

JOB NO. 22-243
DWG. NO. 11368
SHEET 1 of 1